

- EN ISO 463
Factory standard
- Rotating dial
- Full-metal casing.
Mounting shank and
plunger in hardened
stainless steel
- With or without anti-
shock mechanism
- Adjustable tolerance
markers. Thread
M2,5 for measuring
insert
- Measuring insert
with $\varnothing 3,175$ mm
steel ball tip,
already mounted

Dial $\varnothing 58$ mm – Reading 0,01 mm – Standard and long travel

Precision dial gauges

Standard and long travel models



01419048

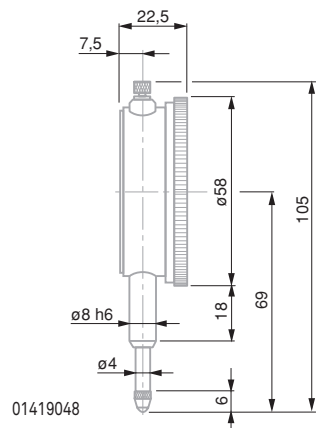

01419048

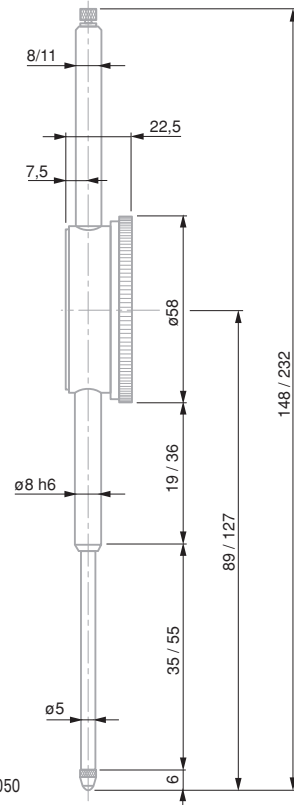

01419050

		mm	mm	mm		N	
01419048		10	0,01	1	0 ÷ 50 ÷ 100	–	≈1
01419050		50	0,01	1	0 ÷ 50 ÷ 100	●	1,5 ÷ 2

For magnetic or central lug backs, see backs for ROCH and ETALON dial gauges

Permissible limits for a metrological characteristic (MPE/MPL)

		mm	10	50
	Deviation span	μm	15	25
	Deviation span within selected partial measuring span 0,10 mm	μm	8	12
	Repeatability Limit	μm	3	3

